

USER AGENCY
 State of Alaska Department of Public Safety (DPS)
 Alaska State Scientific Crime Detection Laboratory
 Anchorage, AK

PROJECT MANAGEMENT
 State of Alaska Department of Transportation
 and Public Facilities (DOT/PF)
 Statewide Facilities Branch
 Anchorage, AK

DESIGN TEAM
 Prime Architect: Livingston Slone, Inc., Anchorage, AK
 Public Safety Associate Architect: McClaren, Wilson, Lawrie, Inc., Roanoke, VA
 Structural Engineer: Reid Middleton, Inc., Anchorage, AK
 Mechanical/Electrical Engineer: AMC Engineers, Anchorage, AK

CONSTRUCTION TEAM
 Construction Manager/
 General Contractor: Neeser Construction, Inc., Anchorage, AK
 Mechanical Contractor: Udelhoven, Inc., Anchorage, AK
 Electrical Contractor: Mega Watt Electric, Inc., Anchorage, AK



Why is the timing of funding urgent?

The new crime lab is in the design phase, with design completion scheduled for March, 2009. The site work design is completed and is "shovel-ready"; building construction could start summer of 2009 if funding is approved during the current 2009 Legislative session. Occupancy is scheduled for the Fall of 2011. Appropriated funding to date provided for design and site work, with a remaining \$94M still needed to complete this project on time. Any delays in funding will add additional costs to the project. A one-year delay will add \$7M to the project's cost.

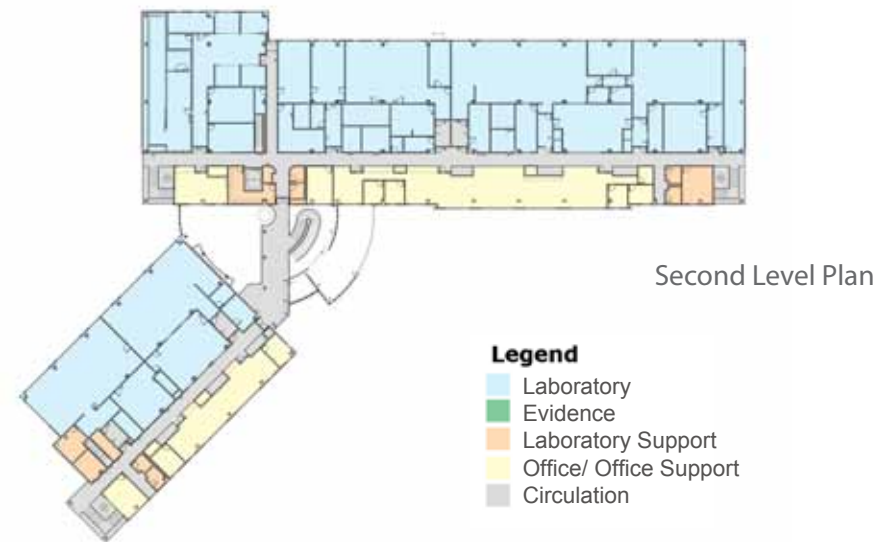

The land for the new crime lab is owned by the Municipality of Anchorage. They are leasing the site to the Department of Public Safety for a 50 year/+ 25 lease term, @ \$1.00/per year . This represents a huge cost savings.



SAFETY, SECURITY AND JUSTICE



"The bottom line is that average citizens are not concerned about forensic science until they, or someone they love, become the victim of a crime. As a result, crime laboratories do not receive the public attention and support that they deserve. This negligence results in low staffing, low salaries, outdated equipment, and eventually, high backlogs."
 ~ Crime Lab Report, 2008 (www.crimelabreport.com)

**ALASKA STATE SCIENTIFIC CRIME
 DETECTION LABORATORY**

